

- WINDOW SCHEDULE:**
- A. TIMBER FRAMED HOPPER
900w. X 900h.
 - B. ALUMINIUM FRAMED SLIDING GLASS
1500w. X 1200h.
 - C. TIMBER FRAMED HOPPER
900w. X 1200h.
 - C. TIMBER FRAMED FIXED GLASS
1400w. X 1200h.

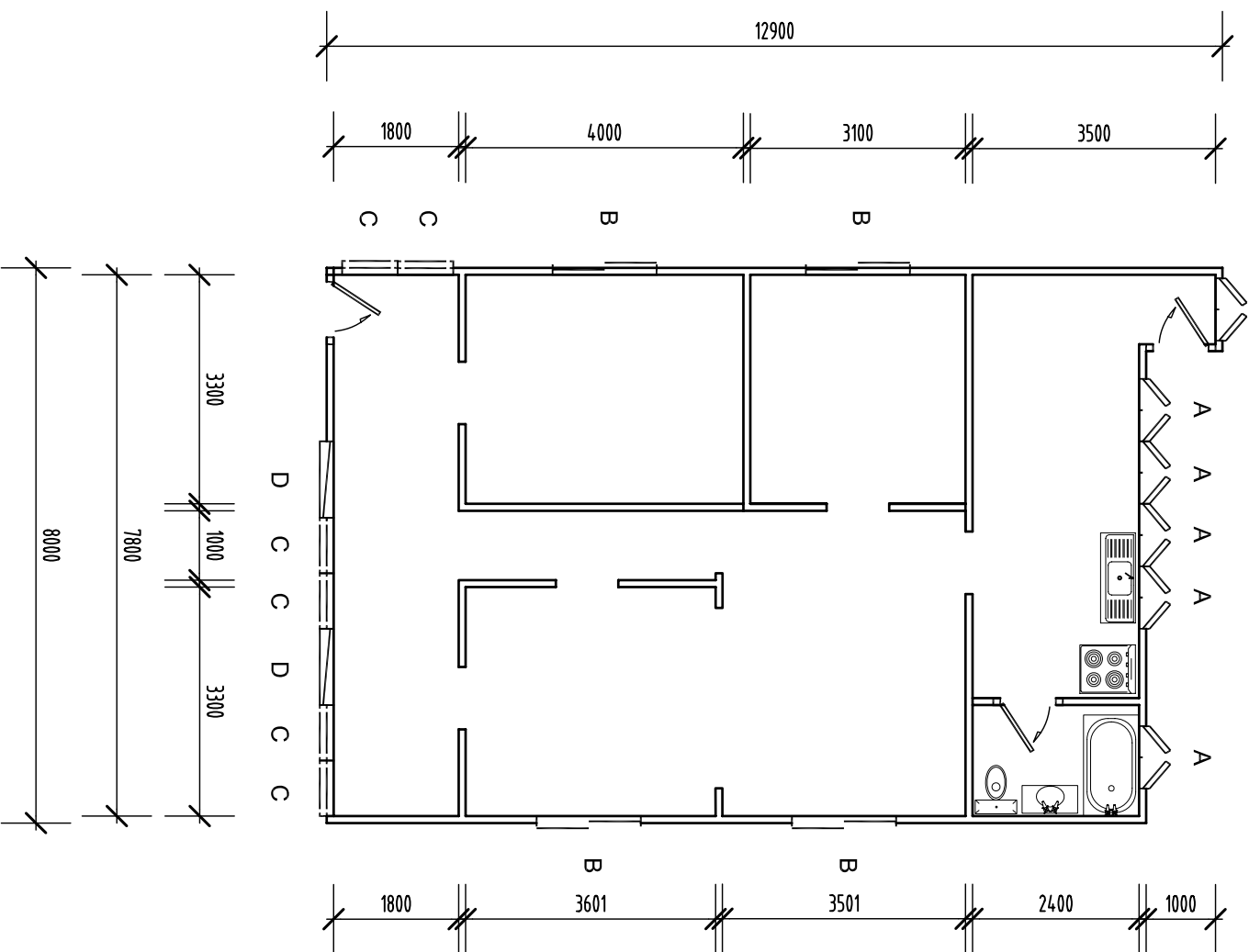

CEILING : 3200 PINE V.J.
 FLOORING : 150mm PINE.
 WALLS : PINE V.J.

MACKAY & SONS HOUSE REMOVALS

WITH COMPLIMENTS FROM:
www.houseremovals.com.au
 PH. (07) 3888 9399
 FAX. (07) 3888 9344

LIVING AREA 91.6m²

NOTES:
 BUILDING DIMENSIONS & WINDOW SIZES INDICATIVE ONLY
 DRAWING NOT TO BE USED FOR CONSTRUCTION
 PURPOSES, FOR SALES PURPOSES ONLY



King Engineering

136 Woodend Road
 Woodend QLD 4505
 Ph: 5812 3445 Fax: 5812 3445

MARK KINZ:
 ME. CR. ENG. REG. (28718)
 NFER 3, (183580),
 QPSA, PES, RLT, (201655)

PROJECT: PROPOSED REMOVAL HOUSE
 HOUSE 7

CLIENT: eee

DRAWING: EXISTING/PROPOSED
 FLOOR PLAN

DATE: BBB **DRAWN:** A.K

JOB NO: CCC **PAGE:** 01

SCALE: 1:100 ON A3

ISSUE	
A	SALES DRAWING
	COMMENT