

WINDOW SCHEDULE:

- A. TIMBER FRAMED SLIDING GLASS
1400w. X 1000h.
- B. ALUMINIUM FRAMED LUVER
1000w. X 400h.
- C. TIMBER FRAMED
800w. X 1400h.
- D. TIMBER FRAMED
900w. X 400h.
- E. ALUMINIUM FRAMED
800w. X 1200h.
- F. TIMBER FRAMED
900w. X 1600h.
- G. ALUMINIUM FRAMED
400w. X 1000h.
- H. TIMBER FRAMED FIXED GLASS
1400w. X 1200h.
- I. TIMBER FRAMED FIXED GLASS
1400w. X 1200h.

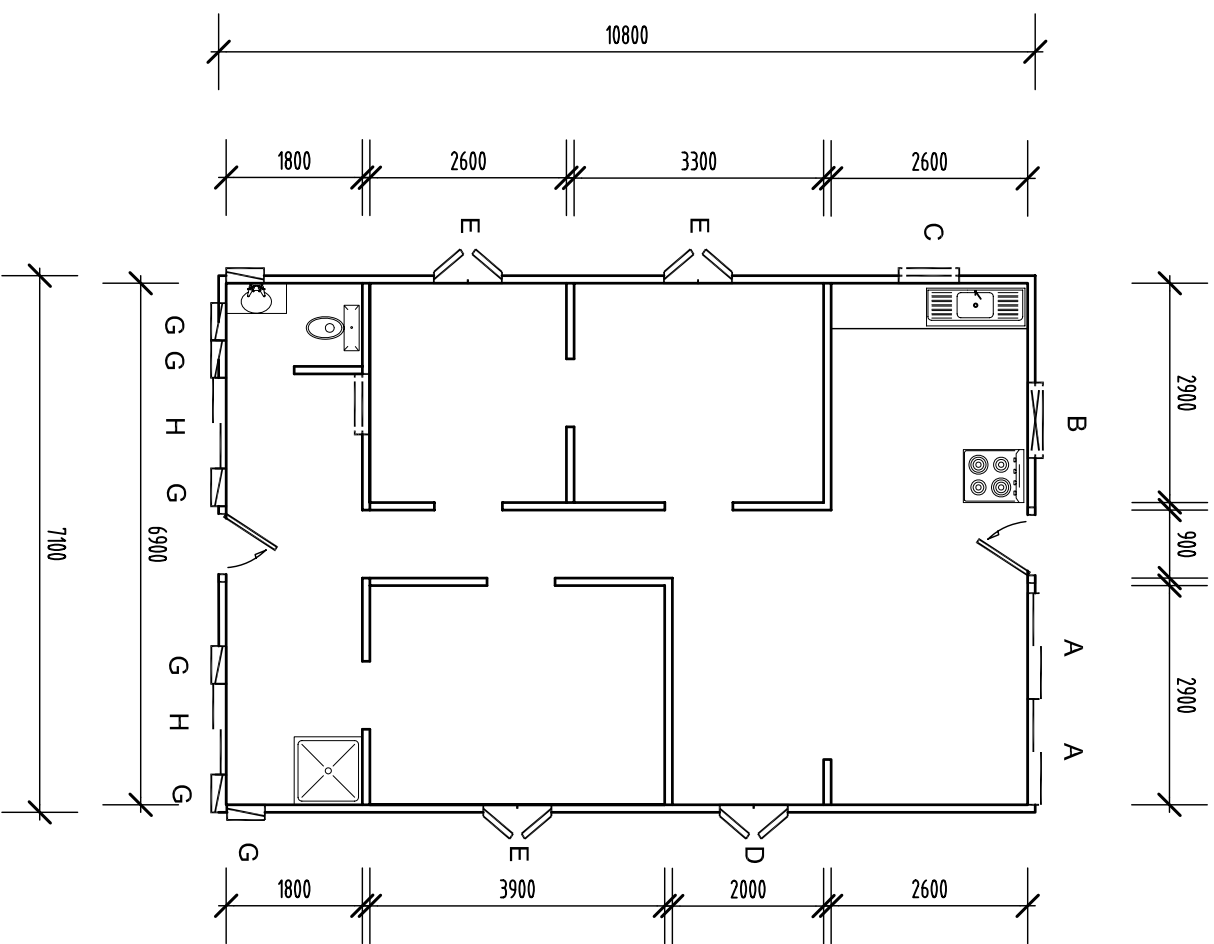

CEILING : 2900 PINE VJ.
 FLOORING : 150mm PINE.
 WALLS : PINE VJ.

NOTES:

BUILDING DIMENSIONS & WINDOW SIZES INDICATIVE ONLY
 DRAWING NOT TO BE USED FOR CONSTRUCTION
 PURPOSES, FOR SALES PURPOSES ONLY

WITH COMPLIMENTS FROM:

MACKAY & SONS HOUSE REMOVALS

www.houseremovals.com.au

PH. (07) 3888 9399

FAX. (07) 3888 9344

LIVING AREA 91.6m²



King Engineering

136 Woodend Road
 Woodend QLD 4505
 Ph: 5812 3445 Fax: 5812 3445

MARK KINK:
 MIE, CP, ENR, REFR. (28718)
 NFR 3, (183580),
 O95A, P55, R12, (201655)

PROJECT: PROPOSED REMOVAL HOUSE
 HOUSE N

CLIENT: eee

DRAWING: EXISTING/PROPOSED
 FLOOR PLAN

DATE: BBB

DRAWN: A.K

JOB NO: CCC

PAGE: 01

SCALE: 1:100 ON A3

ISSUE

A SALES DRAWING
 COMMENT